

RIEPILOGO SLP progetto

Slp P.Terra = $(32,00 \times 13,20) = 422,40 \text{ mq}$

Slp Sopralco = $(12,80 \times 11,70) + (1,20 \times 4,00) = 154,56 \text{ mq}$

Slp TOTALE ampieamento = $(422,40 + 154,56) = 576,96 \text{ mq}$

PIANO PRIMO PROGETTO

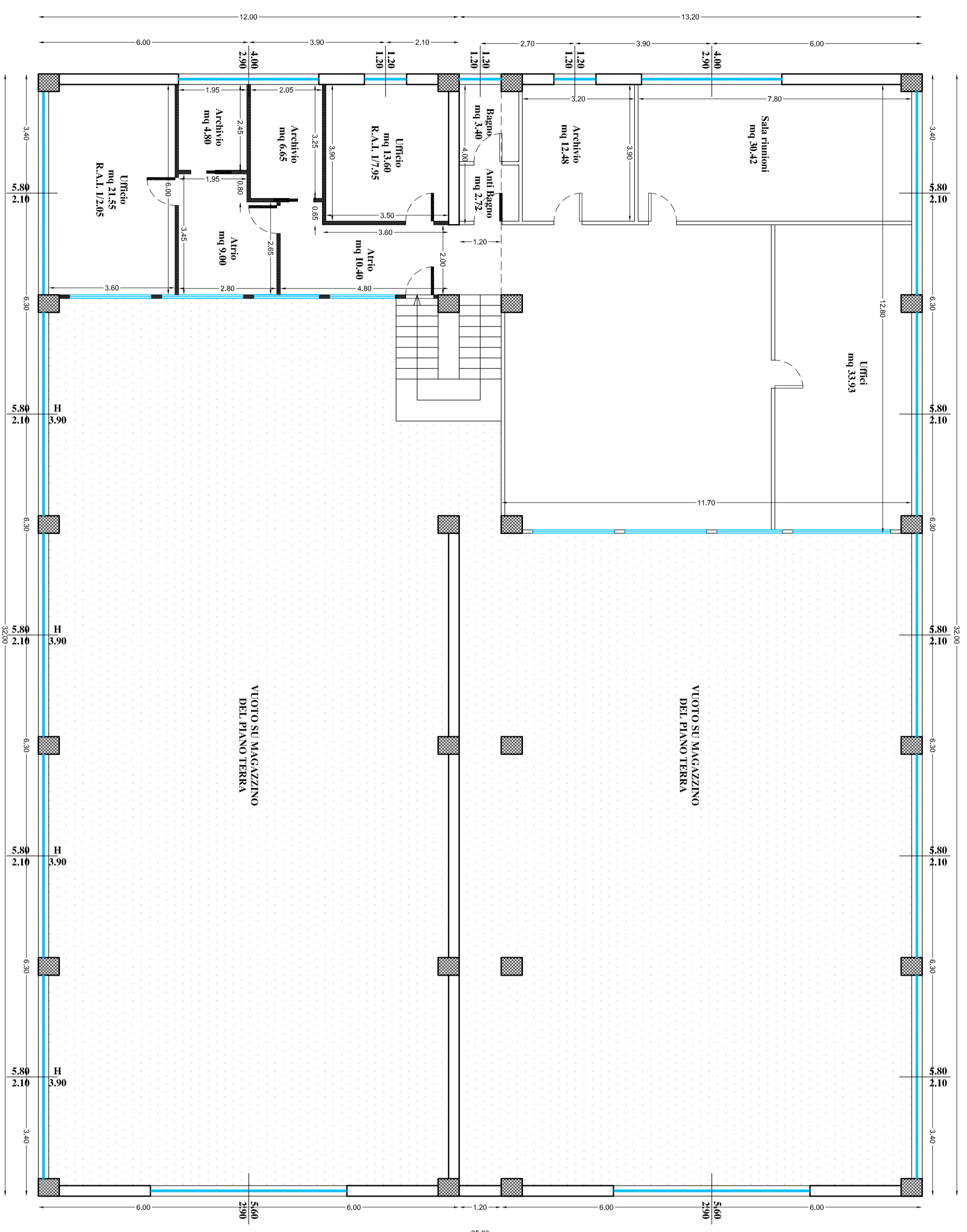

PIANO TERRA PROGETTO

